

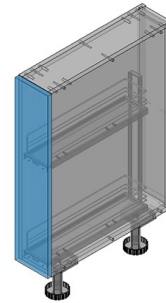

UDUIT has a range of design solutions to help add functionality to your kitchen
All units come with hardware to fully assemble the unit. This range is not shown online, but is available on request.
See last page on how to add these cabinets to your quote.

NOTE: changes to size, colour and construction may differ from that shown. Please confirm with UDUIT as to your needs.



Cabinet Size
H = 870mm
W = 150mm
D = 580mm



Comes with Base pullout shelving system in chrome

Base 1 door 150mm wide chrome pullout

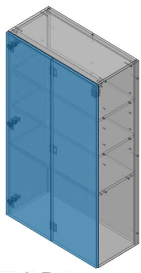

2 Door

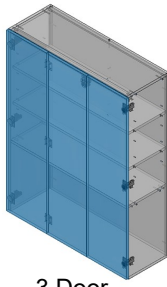

3 Door

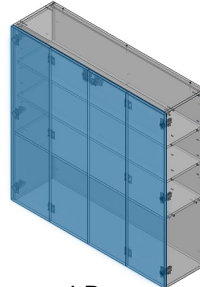

4 Door

OnBench Pantry Cabinet

Cabinet Size

Height from 900mm to 1500mm

Width from 600mm to 1000mm

Depth from 250mm to 560mm

Sizes will determine door configuration.

- 2 door, 3 door, and 4 door bifold options, dependant on size

Can be ordered in variable heights, width and depths to suit bench height.

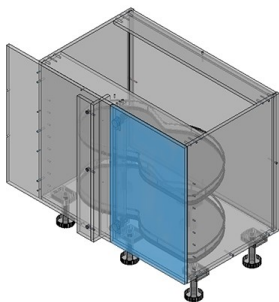

Cabinet Size

H = 870mm

W = 900mm

D = 628mm



Comes with Lemans pullout shelving system

Important info

Cabinet requires 1080mm space

Base Blind cabinet with Lemans Pullout

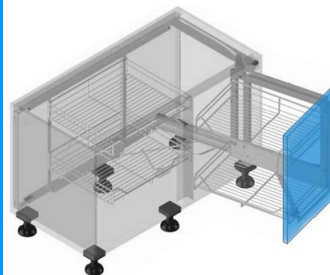

Cabinet Size

H = 870mm

W = 900mm

D = 628mm



Comes with Magic corner pullout shelving system

Important info

Cabinet requires 1080mm space

Base Blind cabinet with Magic corner pullout

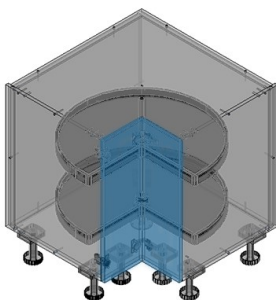

Cabinet Size

H = 870mm

W = 900mm

W = 900mm

D = 580mm



Comes with Lazy susan shelving system

Base corner Cabinet 900 x 900 with Lazy Susan



Cabinet Size

H = 870mm

W = 900mm

W = 900mm

D = 580mm



Unit is supplied preassembled
Doors will need to be fitted

Doors fold into unit

Mondo Base corner cabinet 900 x 900

Drawer Pantry cabinets

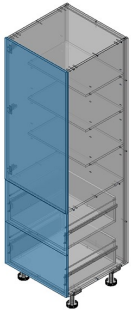

Cabinet Size

H = 1500 to 2250 ex 150mm toespace

W = 300 to 600

D = 540 to 700mm

1 Door 2 Drawer Pantry Cabinets

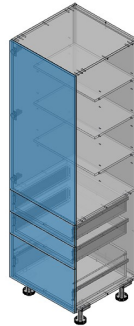

Cabinet Size

H = 1500 to 2250 ex 150mm toespace

W = 300 to 600

D = 540 to 700mm

1 Door 3 Drawer Pantry Cabinets

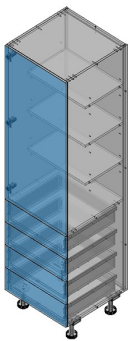

Cabinet Size

H = 1500 to 2250 ex 150mm toespace

W = 300 to 600

D = 540 to 700mm

1 Door 4 Drawer Pantry Cabinets

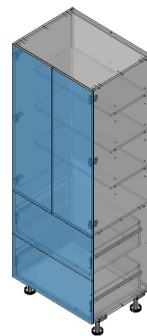

Cabinet Size

H = 1500 to 2250 ex 150mm toespace

W = 600 to 1000mm

D = 540 to 700mm

2 Door 2 Drawer Pantry Cabinets

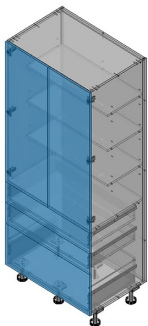

Cabinet Size

H = 1500 to 2250 ex 150mm toespace

W = 600 to 1000mm

D = 540 to 700mm

2 Door 3 Drawer Pantry Cabinets

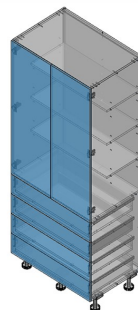

Cabinet Size

H = 1500 to 2250 ex 150mm toespace

W = 600 to 1000mm

D = 540 to 700mm

2 Door 4 Drawer Pantry Cabinets

Pullout Pantry cabinets

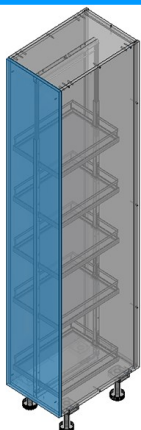

Cabinet Size

H = 2086mm incl 150mm toespace

W = 300mm or 400mm

D = 609mm overall depth

Comes predrilled for
pullout shelving system
Includes Chrome pullout
with 5 chrome wire baskets

Pullout Pantry - Chrome basket

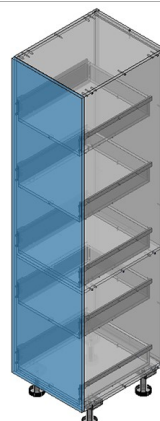

Cabinet Size

H = 2086mm incl 150mm toespace

W = 300mm to 600mm

D = 609mm overall depth

5 Drawers attached to 1
front

Pullout Pantry - Drawer system

Oven cabinets

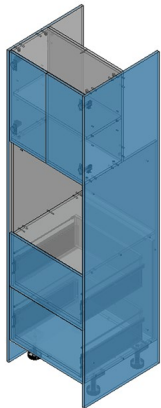

Cabinet Size
H = 2086 to 2400mm
W = 634
D = 560 to 700mm

For single built in ovens

Appliance size will determine suitability of oven tower. Check with UDUIT, email the Make and model.

Bench Height single Oven Tower

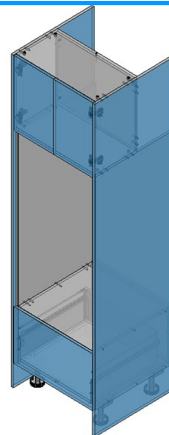

Cabinet Size
H = 2086 to 2400mm
W = 634
D = 560 to 700mm

For Double ovens 850 to 1250mm high

Appliance sizes will determine suitability of oven tower. Check with UDUIT, email the Make and model.

Double Oven Tower 2 doors & 1 Drawer

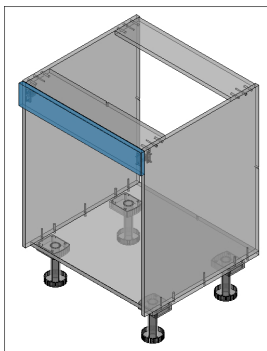

Cabinet Size
H = 720 + 150mm toespace
W = 600 to 900
D = 560 to 700mm

For Induction hobs above an oven.

Appliance size will determine suitability of oven tower. Check with UDUIT, email the Make and model.

Base Oven for Induction Hob

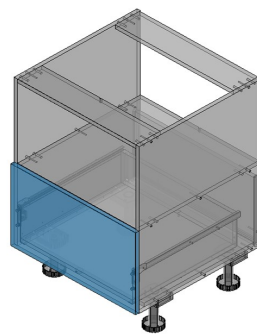

Cabinet Size
H = 720 + 150mm toespace
W = 600 to 900
D = 560 to 700mm

For oven heights between 400mm high and 500mm high

Appliance size will determine suitability of oven tower. Check with UDUIT, email the Make and model.

Base Oven 1 drawer for 3 Quarter Oven

Check with UDUIT for other oven tower combinations to suit your oven specifications

Pantry Corner Cabinet

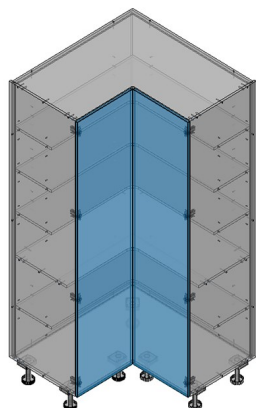

Cabinet Size
H = 1500 to 2250 ex 150mm toespace
WL = 900 to 1050
WR = 900 to 1050
DL = 490 to 700mm
DR = 490 to 700mm

Pantry L Shaped 2 door Cabinet

Décor Cabinets - Coloured cabinet no doors



Cabinet Size
H = 500 to 900mm
W = 150 to 1000mm
D = 335 to 610mm

Cabinet is only available in some colour ranges.
Includes 1 adjustable. Shelf

There is also a no shelf option on request as well as wall options.

Decor Cabinet with shelf - Scullery Cabinets

Alto Drawer upgrade hardware

The Alto drawer system offers an affordable stylish solution with integrated softcloser. The full extension drawer system has been tested to archive a full 35kg weight capacity, making it durable and reliable.

The Alto drawer system is available in all UDUIT drawer configurations.

Ask for a quote and see how affordable this system is. Simply complete an online quote using the standard drawer range. Make sure you generate a quote first. Then email us to swap the drawers for the Alto range of drawers and we will do this for you.



[How do you add cabinets from the Designer range to your quote.](#)

Firstly complete a free online quote. Add in the other cabinets and panels you require into the basket and then generate a quote and complete the process. This will automatically generate a login where the quote will be saved.

Once you have done your initial quote email us the details of the cabinet or cabinets you require. Overall dimensions. Height x width x depth.

Because of some of the technical aspects of these cabinets we may ask you a few questions as well as verify size requirements of some of the cabinets.

We will then add the cabinet to your quote for you.

[Designer range - things you should know.](#)

Non-standard cabinets are supplied in a bulk format. This means the cabinets are still packed by cabinet but the hardware will be supplied in bulk.

Instructions for specific hardware items may be included separately with the hardware item as supplied by the hardware supplier.

The assembly instructions supplied may need to be used in conjunction with hardware installation instructions.

Designer range cabinets will also extend the lead time by 1 or 2 working days. You will be advised at the time of ordering via the system. Please check the dispatch date on the order.