

- Cut out the Cabinets and Panels from pages 1 & 2, then place them on to the grid on Page 3. [Tip: Start with the Base Cabinets, then Tall Cabinets, then Wall Cabinets.](#)
- Some Cabinets have **USIZEIT** flexible width. For these - the Solid line is the minimum width. Dotted lines represent +100mm. [Tip: - Write the flexible Cabinet size on each Cabinet.](#)
- 17mm wide Panels are required next to Base, Tall and Wall Cabinets - anywhere where the side or back of Cabinet can be seen. [Tip: See the guide "Where to use Panels" on page 4.](#)

BASE CABINETS

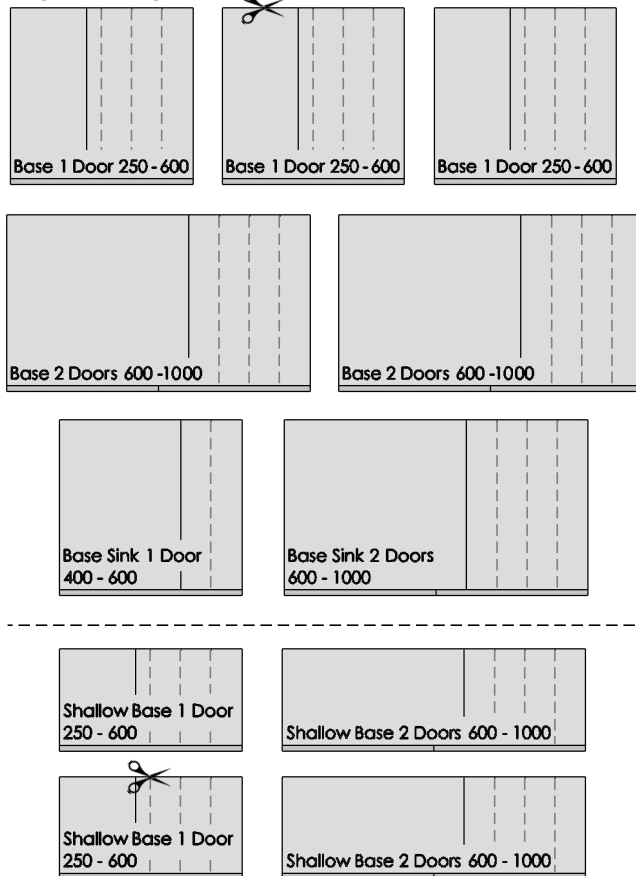

BASE DRAWER CABINETS

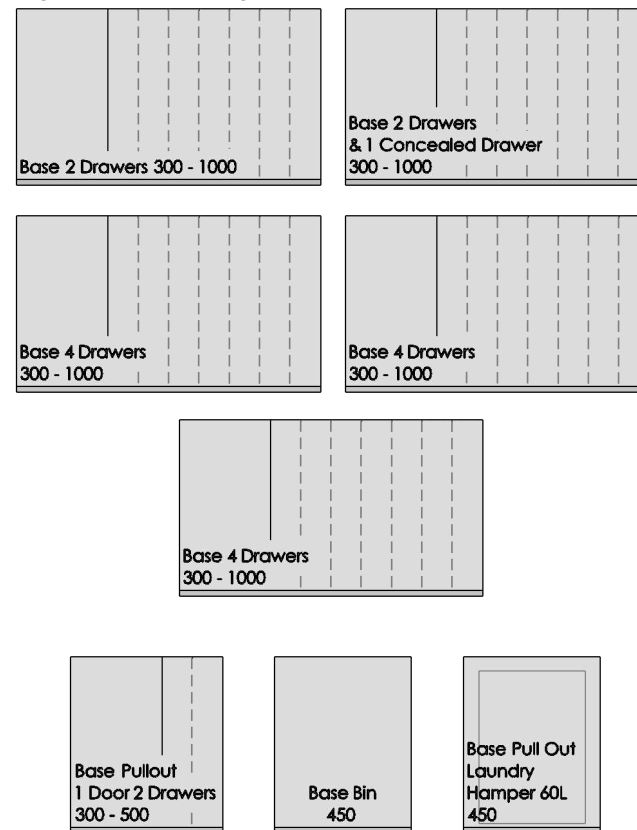

BASE CORNER CABINETS

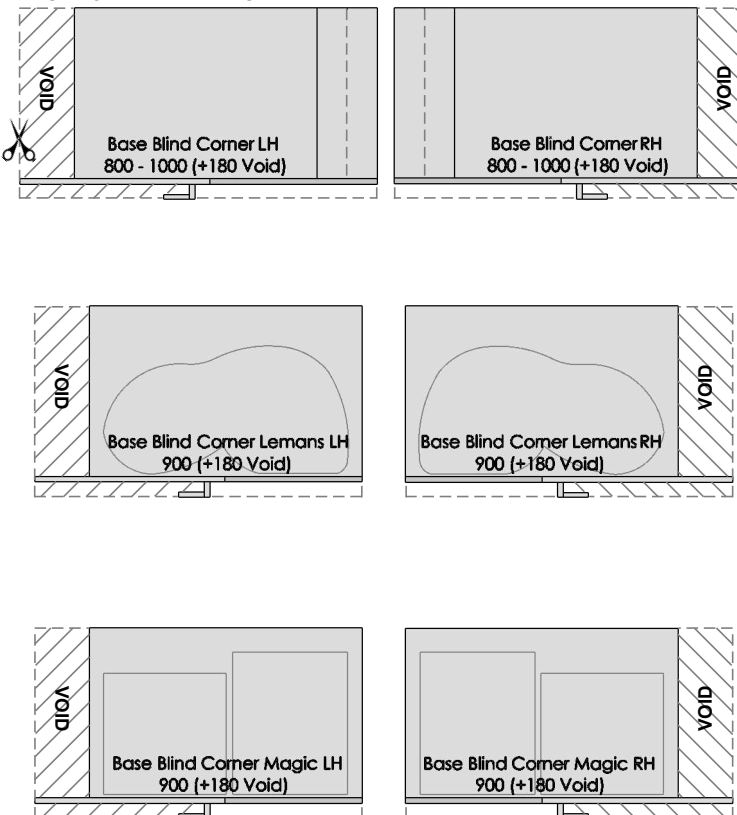

PANELS STANDARD

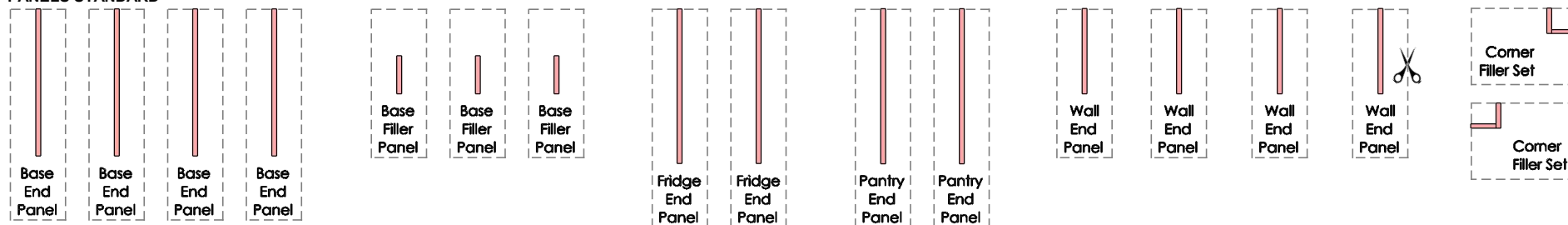

- Cut out the Cabinets and Panels from pages 1 & 2, then place them on to the grid on Page 3. [Tip: Start with the Base Cabinets, then Tall Cabinets, then Wall Cabinets.](#)
- Some Cabinets have **USIZEIT** flexible width. For these - the Solid line is the minimum width. Dotted lines represent +100mm. [Tip: - Write the flexible Cabinet size on each Cabinet.](#)
- 19mm wide Panels are required next to Base, Tall and Wall Cabinets - anywhere where the side or back of Cabinet can be seen. [Tip: See the guide "Where to use Panels" on page 4.](#)

PANTRY CABINETS

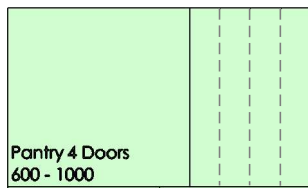
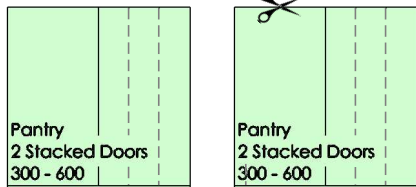

PANTRY DRAWER CABINETS

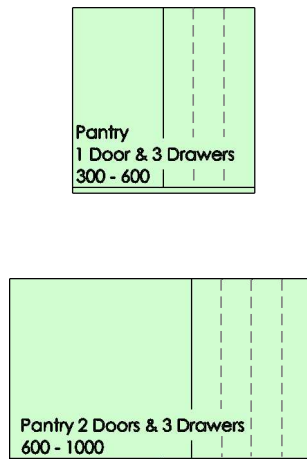
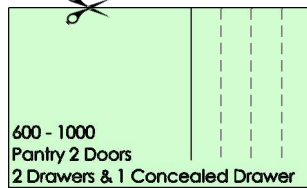
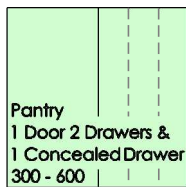
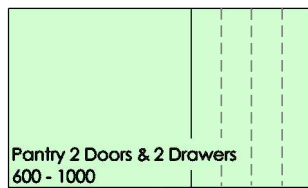
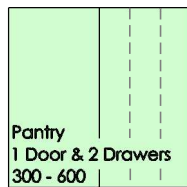

PANTRY CORNER CABINETS

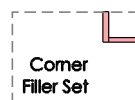
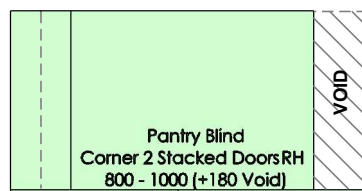
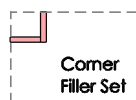
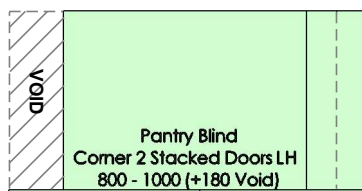

Use Corner Filler Sets between Pantry Blind Corner 2 Stacked Doors Cabinets and adjacent Base Cabinets.

WALL CABINETS

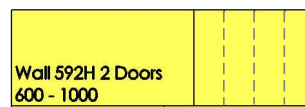
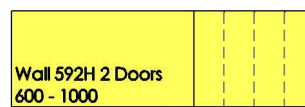
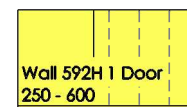
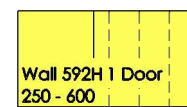
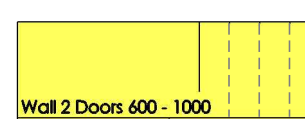
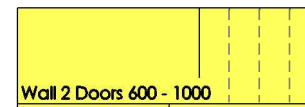
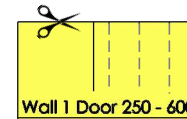
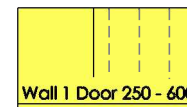

BASE OVEN CABINET

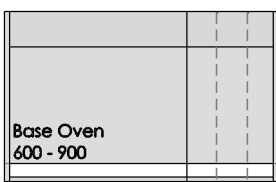

OVEN TOWER CABINETS (Please note: These Cabinets do not require extra End Panels)

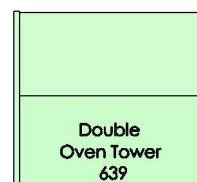

PANELS STANDARD

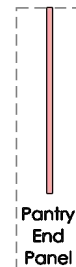
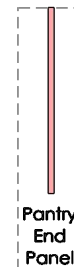

- Place the Cabinets and Panel cutouts on to the grid below... Remember to use USIZEIT flexible widths where you want. [Tip:](#) - Write the flexible Cabinet size on each Cabinet.
- Each square represents 100 mm x 100 mm... Include panels where the side or back of a Cabinet can be seen. [Tip:](#) See the guide "Where to use Panels" on page 4.
- Once you have done your plan and online quote, email us your drawing to check or assist.

	0	1000 mm	2000 mm	3000 mm	4000 mm	5000 mm	6000 mm	7000 mm
0								
1000 mm								
2000 mm								
3000 mm								
4000 mm								